

# SHIMANO

CARDIFF 

CDF-400A

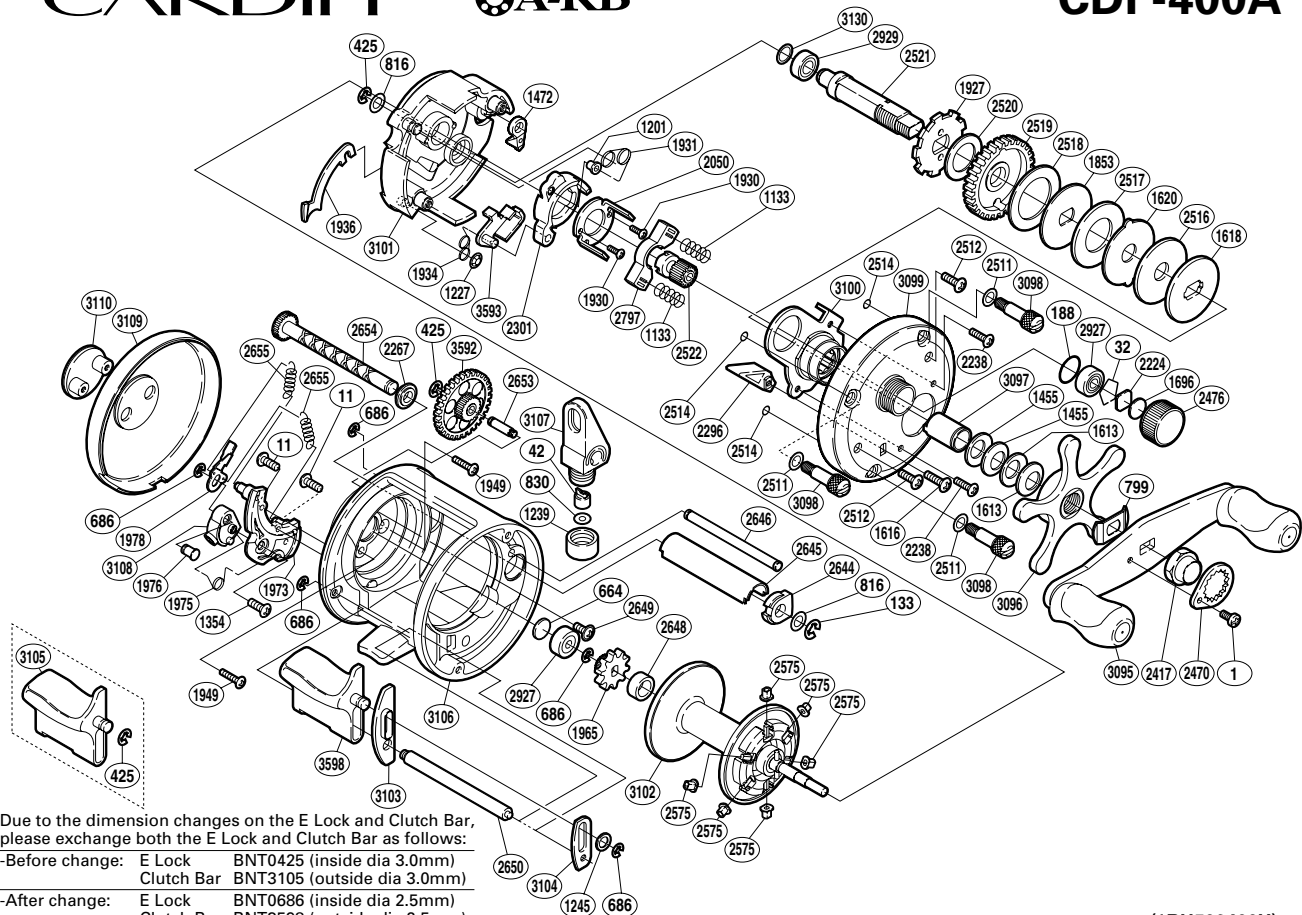

Due to the dimension changes on the E Lock and Clutch Bar, please exchange both the E Lock and Clutch Bar as follows:  
 -Before change: E Lock BNT0425 (inside dia 3.0mm)  
 Clutch Bar BNT3105 (outside dia 3.0mm)  
 -After change: E Lock BNT0686 (inside dia 2.5mm)  
 Clutch Bar BNT3598 (outside dia 2.5mm)

If the wrong combination is used, the reel will not be properly repaired.

(1RH532400U)

Part No.	Description	Part No.	Description	Part No.	Description
BNT0001	Screw	BNT1936	Clutch Plate	BNT2648	Idle Gear A Bush
BNT0011	Screw	BNT1949	Screw	BNT2649	Screw
BNT0032	Bearing Retainer	BNT1965	Idle Gear A	BNT2650	Clutch Button Support Bar
BNT0042	Line Guide Pawl	BNT1973	Click Plate	BNT2653	Idle Gear B Shaft
BNT0133	E Lock	BNT1975	Click Switch Spring	BNT2654	Worm Shaft
BNT0188	O Ring	BNT1976	Click Shaft	BNT2655	Click Spring
BNT0425	E Lock	BNT1978	Click Pawl	BNT2797	Yoke
BNT0664	Spacer B	BNT2050	Clutch Cam Retainer	BNT2927	Ball Bearing
BNT0686	E Lock	BNT2224	Spool Tension Spacer A	BNT2929	Ball Bearing
BNT0799	Friction Washer	BNT2238	Screw	BNT3095	Handle Assembly
BNT0816	Washer	BNT2267	Worm Bushing B	BNT3096	Star Drag
BNT0830	Spacer	BNT2296	Return Pin Guide	BNT3097	Roller Clutch Inner Tube
BNT1133	Yoke Spring	BNT2301	Clutch Cam	BNT3098	Side Plate Nut
BNT1201	Retractor Spring Collar	BNT2417	Handle Nut	BNT3099	Right Side Plate
BNT1227	Push Nut (SPN-2)	BNT2470	Handle Nut Plate	BNT3100	Roller Clutch Assembly
BNT1239	Pawl Cap	BNT2476	Cast Control Cap	BNT3101	Set Plate
BNT1245	Spacer	BNT2511	Washer	BNT3102	Spool Assembly
BNT1354	Screw	BNT2512	Screw	BNT3103	Clutch Button Guide A
BNT1455	Drag Spring Washer H	BNT2514	O Ring	BNT3104	Clutch Button Guide B
BNT1472	Anti-Reverse Pawl	BNT2516	Drag Washer AG	BNT3106	One-Piece Frame
BNT1613	Drag Spring Washer L	BNT2517	Drag Washer CG	BNT3107	Line Guide
BNT1616	Screw	BNT2518	Drag Washer BG	BNT3108	Click Switch
BNT1618	Key Washer C	BNT2519	Drive Gear	BNT3109	Left Side Plate
BNT1620	Eared Washer	BNT2520	Drive Shaft Washer B	BNT3110	Side I.D. Plate
BNT1696	Cast Control Spacer B	BNT2521	Drive Shaft	BNT3130	Washer
BNT1853	Key Washer A	BNT2522	Pinion Gear	BNT3592	Idle Gear B
BNT1927	Anti-Reverse Ratchet	BNT2575	Brake Collar	BNT3593	Clutch Pawl
BNT1930	Screw	BNT2644	Worm Bushing A	BNT3598	Quick-Fire II Clutch Bar
BNT1931	Retractor Spring	BNT2645	Level Wind Guard		
BNT1934	Clutch Pawl Spring	BNT2646	Stabilizer Bar		